

LGEA Presentation Township of Verona

February 11, 2025



New Jersey's
Clean Energy Program

Lighting the way to New Jersey's Clean Energy Future

INTRODUCTIONS

- *Township of Verona*
 - Kevin O'Sullivan
 - Chuck Molinaro
 - Len Waterman
 - Christine Liaukus
- *NJ Clean Energy Program*
 - Sarah Walters – LGEA Project Manager
 - Moussa Traore – LGEA Technical Manager
 - Sayje Essoka-Lasenberry – LGEA Project Auditor
 - Ryan Knippenberg – LGEA Project Auditor
 - Melissa Lott – LGEA Account Manager

AGENDA

- The audit process overview
- Energy use & existing conditions
- Review of **E**nergy **C**onservation **M**easures (ECMs) identified & other recommendations
- Energy Savings Improvement Program (ESIP)
- Energy Efficiency Incentive Programs
- Questions regarding the draft audit report
- Next steps for Township of Verona

LGEA PROCESS

- Application Approval
- Initial Call
- Facility Interviews
- Audit
- Benchmarking & Analysis
- Draft Reports
- LGEA Presentation
- Final Reports

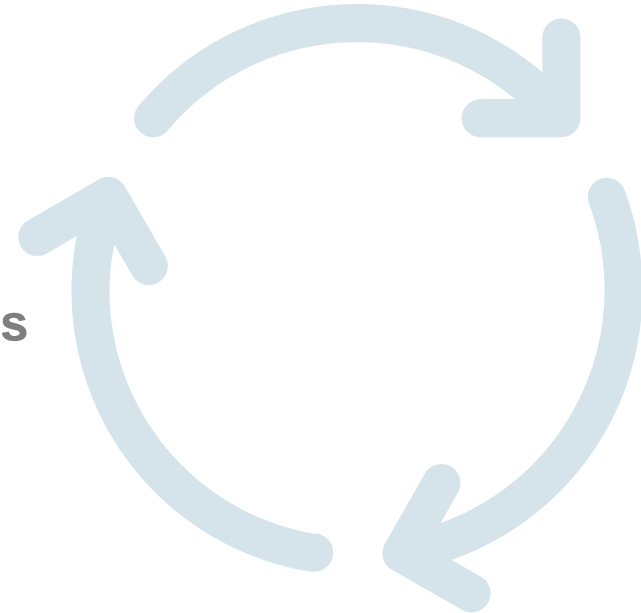

SITE VISIT & UTILITY ANALYSIS

Overview of Systems, Baseline & Existing Conditions:

- Building Envelope
- Lighting System
- HVAC and Mechanical Systems
- Plug Load Equipment
- Food Service and Refrigeration

Utility Consumption:

- Electric Consumption and Costs
- Natural Gas Consumption and Costs

Sites Visited/Analyzed

- Town Hall & Police Station
- Community Center – Main Building & VCC Annex
- Library
- DPW Garages
- B&G Shop
- Firehouse #2
- Waste Water Treatment Plant
- Hillwood Well House
- Verona Community Pool

UTILITY BREAKOUT

Percent of Total Annual Energy Costs

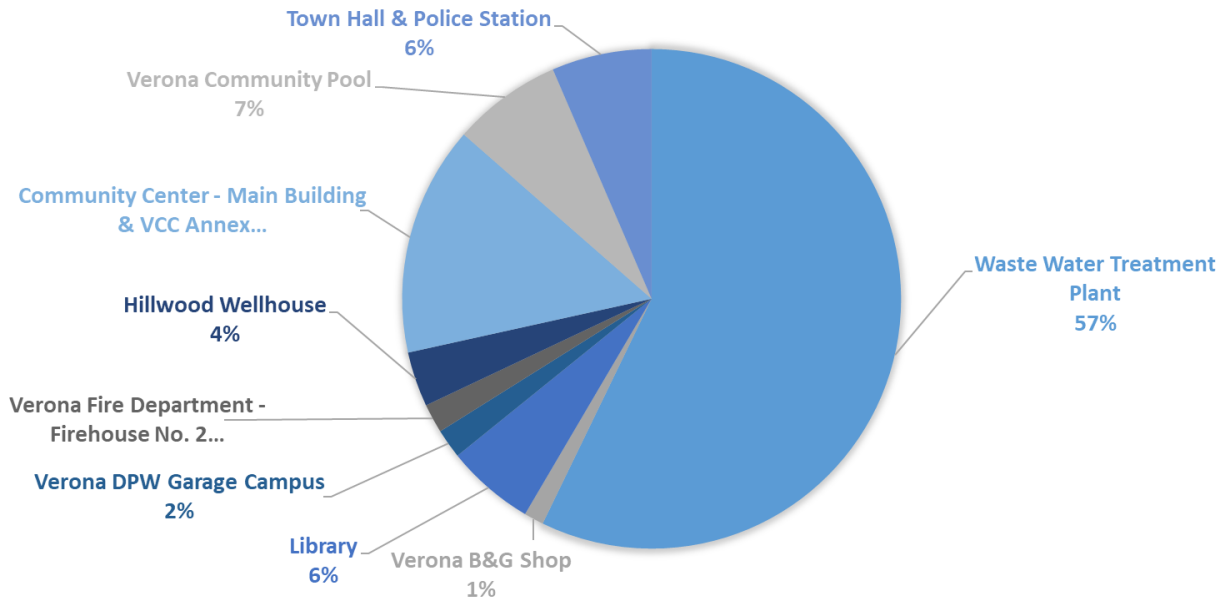

Pre & Post Implementation Cost

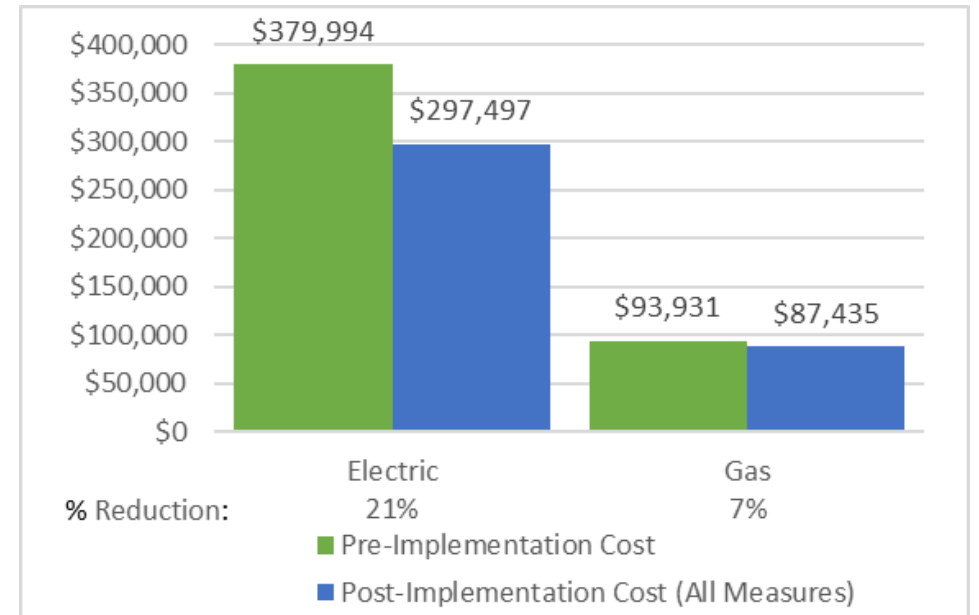

BENCHMARKING

ENERGY STAR® Statement of Energy Performance

11
ENERGY STAR® Score¹

Waste Water Treatment Plant (Campus)

Primary Property Type: Wastewater Treatment Plant
Gross Floor Area (ft²): 19,588
Built: 1928

For Year Ending: September 30, 2023
Date Generated: July 18, 2024

Property & Contact Information

Property Address	Property Owner	Primary Contact
Waste Water Treatment Plant (Campus) 18 Commerce Court Verona, New Jersey 07044	Verona Township 600 Bloomfield Avenue Verona, NJ 07044 (973) 230-4621	Kevin O'Sullivan 600 Bloomfield Avenue Verona, NJ 07044 (973) 230-4621 kosullivan@veronaj.org

Property ID: 33524127

Energy Consumption and Energy Use Intensity (EUI)

Site EUI	Annual Energy by Fuel	National Median Comparison
609.5 kBtu/ft ²	Natural Gas (kBtu): 5,050,870 (51%) Electric - Grid (kBtu): 5,888,483 (49%)	National Median Site EUI (kBtu/ft ²): 381.4 National Median Source EUI (kBtu/ft ²): 729.7 % Diff from National Median Source EUI: 60%
Source EUI	1,166.1 kBtu/ft ²	Annual Emissions Total (Location-Based) GHG Emissions (Metric Tons CO ₂ e/year): 850

Site EUI
609.5 kBtu/ft²

Source EUI
1,166.1 kBtu/ft²

National Median Comparison

National Median Site EUI (kBtu/ft ²)	381.4
National Median Source EUI (kBtu/ft ²)	729.7
% Diff from National Median Source EUI	60%

Site Name	ENERGY STAR® Score
Town Hall & Police Station	N/A
Community Center	N/A
Library	N/A
DPW Garages	N/A
B & G Shop	N/A
Firehouse #2	N/A
WWTP	11
Hillwood Well House	N/A
Verona Community Pool	N/A

ENERGY STAR® scores are percentile ranking from 1 (least efficient) to 100 (most efficient). It compares your building's energy performance to similar buildings nationwide.

Signature & Stamp of Verifying Professional

I, _____ (Name) verify that the above information is true and correct to the best of my knowledge.

LP Signature: _____ Date: _____

Licensed Professional

Professional Engineer or Registered Architect Stamp (if applicable)

BENCHMARKING

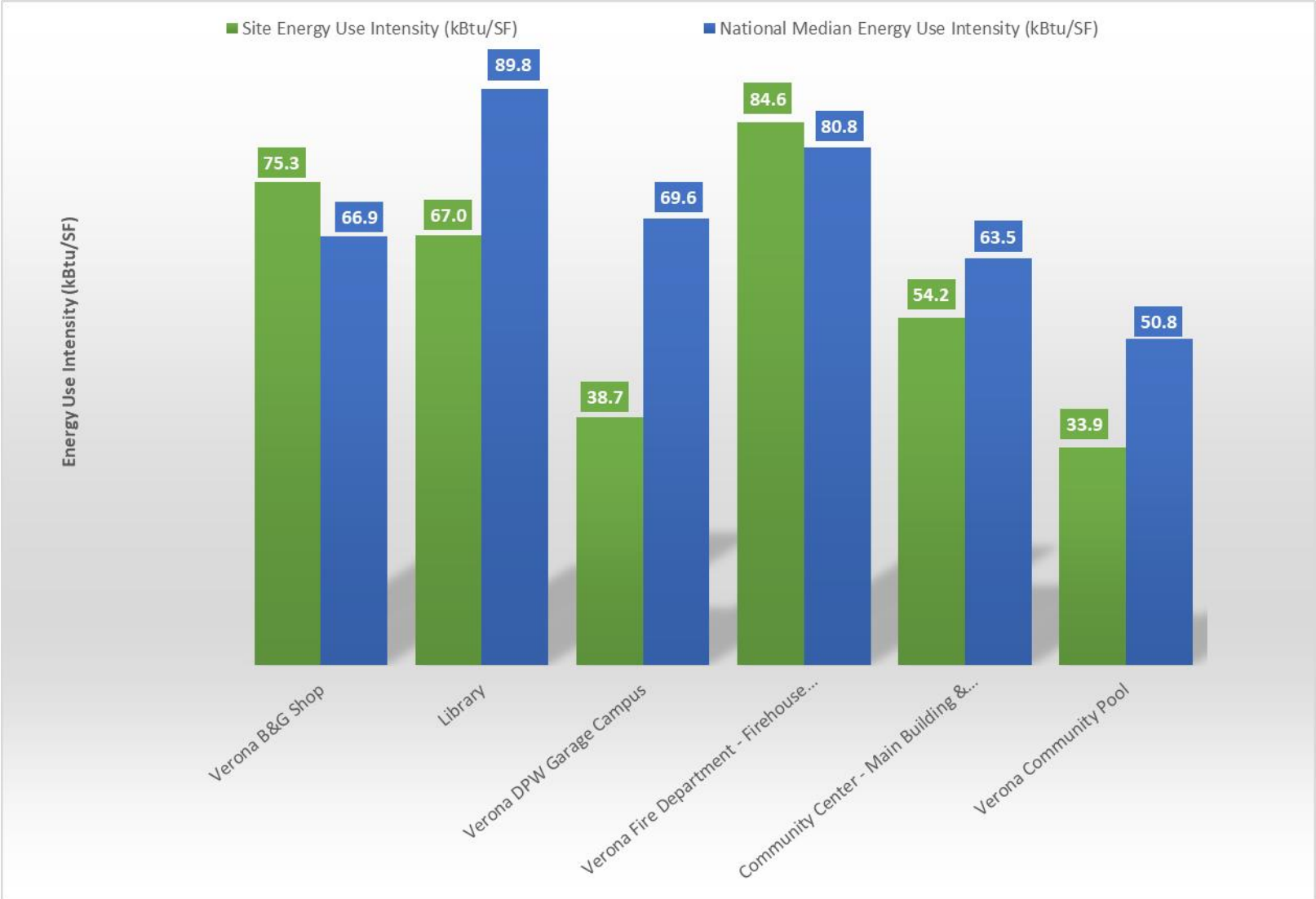

ALL OPPORTUNITIES

Savings Potential

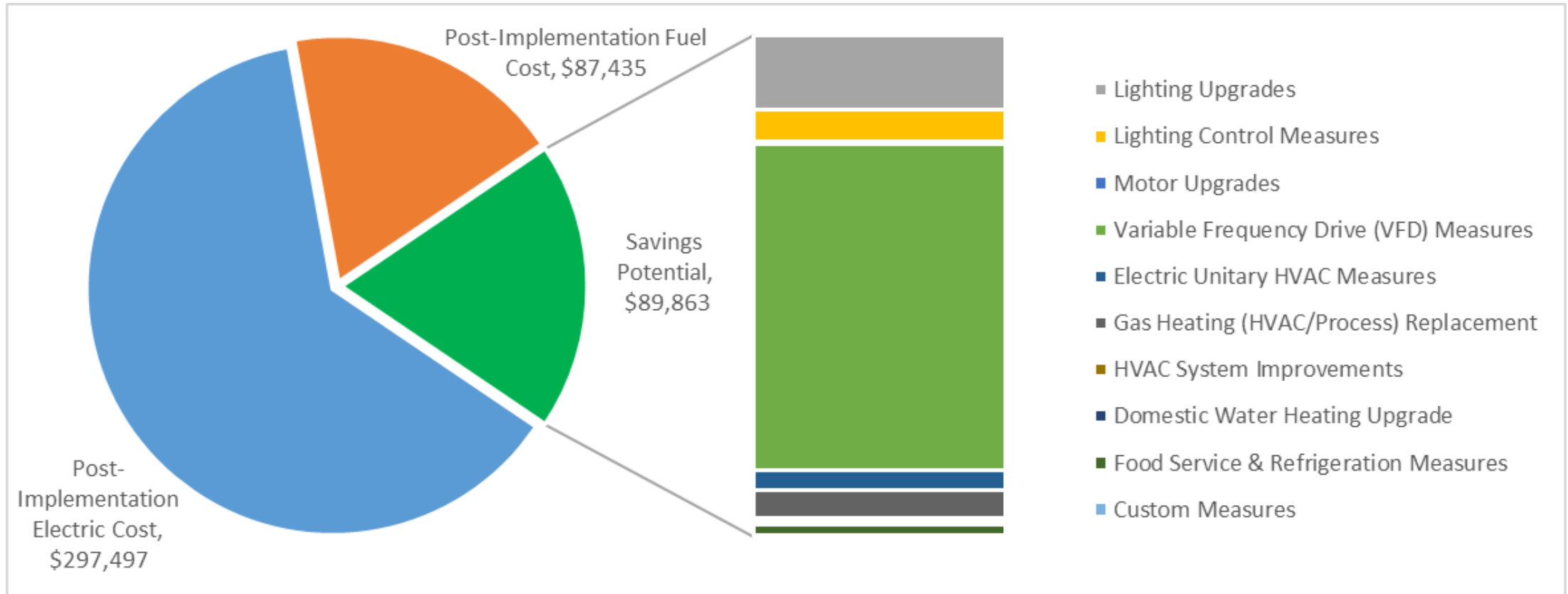

ALL OPPORTUNITIES (1 OF 2)

#	Energy Conservation Measure	Annual Electric Savings (kWh)	Peak Demand Savings (kW)	Annual Fuel Savings (MMBtu)	Annual Energy Cost Savings (\$)	Estimated M&L Cost (\$)	Estimated Incentive (\$)*	Estimated Net M&L Cost (\$)	Simple Payback Period (yrs)**	CO ₂ e Emissions Reduction (lbs)
Lighting Upgrades		82,948	25.9	-7.4	\$13,225	\$67,150	\$10,530	\$56,620	4.3	82,662
ECM 1	Install LED Fixtures	37,827	4.5	-2.1	\$5,009	\$40,120	\$6,220	\$33,900	6.8	37,845
ECM 2	Retrofit Fluorescent Fixtures with LED Lamps and Drivers	1,670	0.4	-0.4	\$241	\$860	\$100	\$760	3.2	1,640
ECM 3	Retrofit Fixtures with LED Lamps	43,451	21.0	-4.9	\$7,975	\$26,170	\$4,210	\$21,960	2.8	43,176
Lighting Control Measures		34,045	10.5	-6.8	\$5,882	\$57,400	\$10,500	\$46,900	8.0	33,486
ECM 4	Install Occupancy Sensor Lighting Controls	30,405	9.6	-6.0	\$5,272	\$49,260	\$5,830	\$43,430	8.2	29,912
ECM 5	Install High/Low Lighting Controls	3,640	0.9	-0.8	\$610	\$8,140	\$4,670	\$3,470	5.7	3,575
Motor Upgrades		2,213	0.6	0.0	\$367	\$8,100	\$0	\$8,100	22.1	2,228
ECM 6	Premium Efficiency Motors	2,213	0.6	0.0	\$367	\$8,100	\$0	\$8,100	22.1	2,228
Variable Frequency Drive (VFD) Measures		407,020	71.2	0.0	\$58,429	\$254,700	\$11,700	\$243,000	4.2	409,866
ECM 7	Install VFDs on Constant Volume (CV) Fans	80,144	24.3	0.0	\$14,927	\$130,400	\$8,000	\$122,400	8.2	80,704
ECM 8	Install VFDs on Heating Water Pumps	11,327	1.5	0.0	\$2,124	\$30,000	\$1,500	\$28,500	13.4	11,406
ECM 9	Install VFDs on Process/Pool Filtration Pumps	315,549	45.4	0.0	\$41,378	\$94,300	\$2,200	\$92,100	2.2	317,755
Unitary HVAC Measures		20,242	19.0	0.0	\$3,628	\$221,700	\$9,600	\$212,100	58.5	20,384
ECM 10	Install High Efficiency Air Conditioning Units	17,552	16.2	0.0	\$3,182	\$195,600	\$8,600	\$187,000	58.8	17,675
ECM 11	Install High Efficiency Heat Pumps	2,690	2.8	0.0	\$446	\$26,100	\$1,000	\$25,100	56.2	2,709

ALL OPPORTUNITIES (2 OF 2)

#	Energy Conservation Measure	Annual Electric Savings (kWh)	Peak Demand Savings (kW)	Annual Fuel Savings (MMBtu)	Annual Energy Cost Savings (\$)	Estimated M&L Cost (\$)	Estimated Incentive (\$)*	Estimated Net M&L Cost (\$)	Simple Payback Period (yrs)**	CO ₂ e Emissions Reduction (lbs)
Gas Heating (HVAC/Process) Replacement		0	0.0	498.6	\$4,956	\$194,000	\$10,500	\$183,500	37.0	58,375
ECM 12	Install High Efficiency Hot Water Boilers	0	0.0	339.5	\$3,435	\$170,800	\$8,000	\$162,800	47.4	39,747
ECM 13	Install High Efficiency Furnaces	0	0.0	159.1	\$1,521	\$23,200	\$2,500	\$20,700	13.6	18,628
HVAC System Improvements		507	0.0	29.6	\$442	\$1,790	\$130	\$1,660	3.8	3,978
ECM 14	Install Programmable Thermostats	222	0.0	8.8	\$170	\$760	\$0	\$760	4.5	1,249
ECM 15	Install Pipe Insulation	286	0.0	20.8	\$272	\$1,030	\$130	\$900	3.3	2,729
Domestic Water Heating Upgrade		343	0.0	29.1	\$624	\$3,210	\$420	\$2,790	4.5	4,469
ECM 16	Install High Efficiency Gas-Fired Water Heater	0	0.0	1.8	\$21	\$2,200	\$200	\$2,000	93.8	206
ECM 17	Install Low-Flow DHW Devices	343	0.0	27.4	\$603	\$1,010	\$220	\$790	1.3	4,263
Food Service & Refrigeration Measures		9,953	1.1	0.0	\$1,874	\$2,160	\$300	\$1,860	1.0	10,023
ECM 18	Vending Machine Control	9,953	1.1	0.0	\$1,874	\$2,160	\$300	\$1,860	1.0	10,023
Custom Measures		-9,423	0.0	110.0	-\$435	\$17,400	\$0	\$17,400	-40.0	3,391
ECM 19	Replace Electric Water Heater with Heat Pump Water Heater	809	0.0	0.0	\$99	\$2,500	\$0	\$2,500	25.3	815
ECM 20	Replace Gas Fired Water Heater with Heat Pump Water Heater	-10,232	0.0	110.0	-\$534	\$14,900	\$0	\$14,900	-27.9	2,576
TOTALS (ALL MEASURES)		547,849	128.3	653.1	\$88,993	\$827,610	\$53,680	\$773,930	8.7	628,861

* - All incentives presented in this table are included as placeholders for planning purposes and are based on previously run state rebate programs. Contact your utility provider for details on current programs.

** - Simple Payback Period is based on net measure costs (i.e. after incentives).

COST EFFECTIVE OPPORTUNITIES

Savings Potential

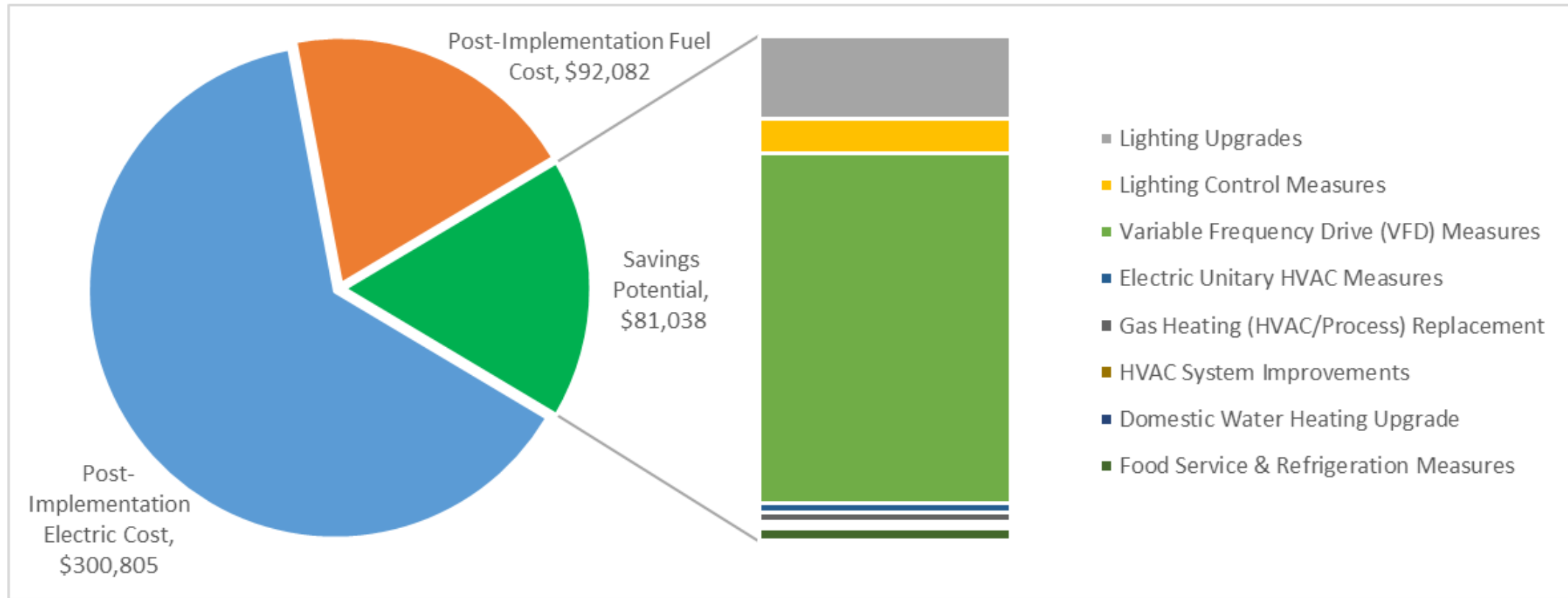

COST EFFECTIVE OPPORTUNITIES (1 OF 2)

#	Energy Conservation Measure	Annual Electric Savings (kWh)	Peak Demand Savings (kW)	Annual Fuel Savings (MMBtu)	Annual Energy Cost Savings (\$)	Estimated M&L Cost (\$)	Estimated Incentive (\$)*	Estimated Net M&L Cost (\$)	Simple Payback Period (yrs)**	CO ₂ e Emissions Reduction (lbs)
Lighting Upgrades		82,948	25.9	-7.4	\$13,225	\$67,150	\$10,530	\$56,620	4.3	82,662
ECM 1	Install LED Fixtures	37,827	4.5	-2.1	\$5,009	\$40,120	\$6,220	\$33,900	6.8	37,845
ECM 2	Retrofit Fluorescent Fixtures with LED Lamps and Drivers	1,670	0.4	-0.4	\$241	\$860	\$100	\$760	3.2	1,640
ECM 3	Retrofit Fixtures with LED Lamps	43,451	21.0	-4.9	\$7,975	\$26,170	\$4,210	\$21,960	2.8	43,176
Lighting Control Measures		32,237	9.1	-6.4	\$5,624	\$53,260	\$9,990	\$43,270	7.7	31,711
ECM 4	Install Occupancy Sensor Lighting Controls	28,597	8.3	-5.6	\$5,013	\$44,640	\$5,320	\$39,320	7.8	28,136
ECM 5	Install Daylight Dimming/Photocell Controls	0	0.0	0.0	\$0	\$480	\$0	\$480	0.0	0
ECM 6	Install High/Low Lighting Controls	3,640	0.9	-0.8	\$610	\$8,140	\$4,670	\$3,470	5.7	3,575
Variable Frequency Drive (VFD) Measures		391,826	68.6	0.0	\$56,210	\$223,800	\$11,000	\$212,800	3.8	394,566
ECM 8	Install VFDs on Constant Volume (CV) Fans	68,501	22.1	0.0	\$13,142	\$108,900	\$7,500	\$101,400	7.7	68,980
ECM 9	Install VFDs on Heating Water Pumps	7,776	1.1	0.0	\$1,690	\$20,600	\$1,300	\$19,300	11.4	7,830
ECM 10	Install VFDs on Process/Pool Filtration Pumps	315,549	45.4	0.0	\$41,378	\$94,300	\$2,200	\$92,100	2.2	317,755
Unitary HVAC Measures		7,364	8.2	0.0	\$1,564	\$108,100	\$4,600	\$103,500	66.2	7,415
ECM 11	Install High Efficiency Air Conditioning Units	7,364	8.2	0.0	\$1,564	\$108,100	\$4,600	\$103,500	66.2	7,415

COST EFFECTIVE OPPORTUNITIES (2 OF 2)

#	Energy Conservation Measure	Annual Electric Savings (kWh)	Peak Demand Savings (kW)	Annual Fuel Savings (MMBtu)	Annual Energy Cost Savings (\$)	Estimated M&L Cost (\$)	Estimated Incentive (\$)*	Estimated Net M&L Cost (\$)	Simple Payback Period (yrs)**	CO ₂ e Emissions Reduction (lbs)
Gas Heating (HVAC/Process) Replacement		0	0.0	151.7	\$1,474	\$24,400	\$1,400	\$23,000	15.6	17,757
ECM 13	Install High Efficiency Hot Water Boilers	0	0.0	20.3	\$246	\$14,100	\$400	\$13,700	55.7	2,382
ECM 14	Install High Efficiency Furnaces	0	0.0	131.3	\$1,228	\$10,300	\$1,000	\$9,300	7.6	15,375
HVAC System Improvements		507	0.0	29.6	\$442	\$1,790	\$130	\$1,660	3.8	3,978
ECM 15	Install Programmable Thermostats	222	0.0	8.8	\$170	\$760	\$0	\$760	4.5	1,249
ECM 16	Install Pipe Insulation	286	0.0	20.8	\$272	\$1,030	\$130	\$900	3.3	2,729
Domestic Water Heating Upgrade		343	0.0	29.1	\$624	\$3,210	\$420	\$2,790	4.5	4,469
ECM 17	Install High Efficiency Gas-Fired Water Heater	0	0.0	1.8	\$21	\$2,200	\$200	\$2,000	93.8	206
ECM 18	Install Low-Flow DHW Devices	343	0.0	27.4	\$603	\$1,010	\$220	\$790	1.3	4,263
Food Service & Refrigeration Measures		9,953	1.1	0.0	\$1,874	\$2,160	\$300	\$1,860	1.0	10,023
ECM 19	Vending Machine Control	9,953	1.1	0.0	\$1,874	\$2,160	\$300	\$1,860	1.0	10,023
TOTALS		525,179	113.0	196.6	\$81,038	\$483,870	\$38,370	\$445,500	5.5	552,580

* - All incentives presented in this table are included as placeholders and are based on previously run state rebate programs. Contact your utility provider for details on current programs

** - Simple Payback Period is based on net measure costs (i.e. after incentives).

TOWN HALL & POLICE STATION

#	Energy Conservation Measure	Cost Effective?	Annual Electric Savings (kWh)	Peak Demand Savings (kW)	Annual Fuel Savings (MMBtu)	Annual Energy Cost Savings (\$)	Estimated M&L Cost (\$)	Estimated Incentive (\$)*	Estimated Net M&L Cost (\$)	Simple Payback Period (yrs)**	CO ₂ e Emissions Reduction (lbs)
Lighting Upgrades			9,840	1.3	-2	\$1,485	\$1,770	\$340	\$1,430	1.0	9,680
ECM 1	Install LED Fixtures	Yes	657	0.0	0	\$101	\$510	\$200	\$310	3.1	662
ECM 2	Retrofit Fluorescent Fixtures with LED Lamps and Drivers	Yes	1,322	0.2	0	\$199	\$240	\$30	\$210	1.1	1,298
ECM 3	Retrofit Fixtures with LED Lamps	Yes	7,861	1.1	-2	\$1,185	\$1,020	\$110	\$910	0.8	7,720
Lighting Control Measures			16,021	2.5	-3	\$2,415	\$11,360	\$2,150	\$9,210	3.8	15,733
ECM 4	Install Occupancy Sensor Lighting Controls	Yes	14,468	2.3	-3	\$2,181	\$9,960	\$1,200	\$8,760	4.0	14,209
ECM 5	Install High/Low Lighting Controls	Yes	1,553	0.2	0	\$234	\$1,400	\$950	\$450	1.9	1,525
Variable Frequency Drive (VFD) Measures			11,643	2.2	0	\$1,785	\$21,500	\$500	\$21,000	11.8	11,724
ECM 6	Install VFDs on Constant Volume (CV) Fans	No	11,643	2.2	0	\$1,785	\$21,500	\$500	\$21,000	11.8	11,724
Unitary HVAC Measures			7,408	5.6	0	\$1,135	\$67,800	\$3,000	\$64,800	57.1	7,460
ECM 7	Install High Efficiency Air Conditioning Units	No	6,502	4.3	0	\$997	\$62,700	\$2,800	\$59,900	60.1	6,547
ECM 8	Install High Efficiency Heat Pumps	No	906	1.2	0	\$139	\$5,100	\$200	\$4,900	35.3	913
Gas Heating (HVAC/Process) Replacement			0	0.0	36	\$434	\$34,800	\$1,900	\$32,900	75.8	4,249
ECM 9	Install High Efficiency Hot Water Boilers	No	0	0.0	36	\$434	\$34,800	\$1,900	\$32,900	75.8	4,249
HVAC System Improvements			0	0.0	9	\$110	\$350	\$40	\$310	2.8	1,078
ECM 10	Install Pipe Insulation	Yes	0	0.0	9	\$110	\$350	\$40	\$310	2.8	1,078
Domestic Water Heating Upgrade			0	0.0	3	\$42	\$80	\$30	\$50	1.2	408
ECM 11	Install Low-Flow DHW Devices	Yes	0	0.0	3	\$42	\$80	\$30	\$50	1.2	408
Custom Measures***			-2,363	0.0	25	-\$63	\$2,900	\$0	\$2,900	-46.0	548
ECM 12	Replace Gas Fired Water Heater with Heat Pump Water Heater***	No	-2,363	0.0	25	-\$63	\$2,900	\$0	\$2,900	-46.0	548
TOTALS (COST EFFECTIVE MEASURES)			25,861	3.8	7	\$4,052	\$13,560	\$2,560	\$11,000	2.7	26,901
TOTALS (ALL MEASURES)			42,549	11.6	69	\$7,343	\$140,560	\$7,960	\$132,600	18.1	50,881

* - All incentives presented in this table are included as placeholders for planning purposes and are based on previously run state rebate programs. Contact your utility provider for details on current programs.

** - Simple Payback Period is based on net measure costs (i.e. after incentives).

*** - Negative payback explained in section 4.8

COMMUNITY CENTER

#	Energy Conservation Measure	Cost Effective?	Annual Electric Savings (kWh)	Peak Demand Savings (kW)	Annual Fuel Savings (MMBtu)	Annual Energy Cost Savings (\$)	Estimated M&L Cost (\$)	Estimated Incentive (\$)*	Estimated Net M&L Cost (\$)	Simple Payback Period (yrs)**	CO ₂ e Emissions Reduction (lbs)
Lighting Upgrades			7,024	3.4	-1	\$1,531	\$15,510	\$3,020	\$12,490	8.2	6,947
ECM 1	Install LED Fixtures	Yes	1,971	0.0	0	\$432	\$9,780	\$1,800	\$7,980	18.5	1,985
ECM 2	Retrofit Fixtures with LED Lamps	Yes	5,053	3.4	-1	\$1,098	\$5,730	\$1,220	\$4,510	4.1	4,963
Lighting Control Measures			7,743	3.3	-2	\$1,683	\$22,230	\$4,310	\$17,920	10.6	7,604
ECM 3	Install Occupancy Sensor Lighting Controls	Yes	7,075	3.1	-2	\$1,537	\$18,300	\$2,190	\$16,110	10.5	6,948
ECM 4	Install High/Low Lighting Controls	Yes	669	0.3	0	\$145	\$3,930	\$2,120	\$1,810	12.5	657
Motor Upgrades			992	0.3	0	\$218	\$4,300	\$0	\$4,300	19.8	999
ECM 5	Premium Efficiency Motors	No	992	0.3	0	\$218	\$4,300	\$0	\$4,300	19.8	999
Variable Frequency Drive (VFD) Measures			49,291	15.3	0	\$10,815	\$90,300	\$5,900	\$84,400	7.8	49,636
ECM 6	Install VFDs on Constant Volume (CV) Fans	Yes	41,851	14.3	0	\$9,182	\$79,600	\$4,800	\$74,800	8.1	42,143
ECM 7	Install VFDs on Heating Water Pumps	Yes	7,440	1.1	0	\$1,632	\$10,700	\$1,100	\$9,600	5.9	7,492
Unitary HVAC Measures			6,418	7.6	0	\$1,408	\$93,000	\$3,900	\$89,100	63.3	6,463
ECM 8	Install High Efficiency Air Conditioning Units	Yes	6,418	7.6	0	\$1,408	\$93,000	\$3,900	\$89,100	63.3	6,463
Gas Heating (HVAC/Process) Replacement			0	0.0	89	\$872	\$53,500	\$3,200	\$50,300	57.7	10,393
ECM 9	Install High Efficiency Hot Water Boilers	No	0	0.0	68	\$664	\$48,600	\$2,700	\$45,900	69.1	7,918
ECM 10	Install High Efficiency Furnaces	No	0	0.0	21	\$208	\$4,900	\$500	\$4,400	21.2	2,475
HVAC System Improvements			0	0.0	9	\$85	\$240	\$30	\$210	2.5	1,018
ECM 11	Install Pipe Insulation	Yes	0	0.0	9	\$85	\$240	\$30	\$210	2.5	1,018
Domestic Water Heating Upgrade			0	0.0	4	\$41	\$140	\$60	\$80	2.0	487
ECM 12	Install Low-Flow DHW Devices	Yes	0	0.0	4	\$41	\$140	\$60	\$80	2.0	487
Food Service & Refrigeration Measures			3,506	0.4	0	\$769	\$1,080	\$100	\$980	1.3	3,530
ECM 13	Vending Machine Control	Yes	3,506	0.4	0	\$769	\$1,080	\$100	\$980	1.3	3,530
Custom Measures***			-2,954	0.0	32	-\$334	\$4,200	\$0	\$4,200	-12.6	772
ECM 14	Replace Gas Fired Water Heater with Heat Pump Water Heater***	No	-2,954	0.0	32	-\$334	\$4,200	\$0	\$4,200	-12.6	772
TOTALS (COST EFFECTIVE MEASURES)			73,982	30.1	10	\$16,332	\$222,500	\$17,320	\$205,180	12.6	75,685
TOTALS (ALL MEASURES)			72,020	30.4	131	\$17,087	\$284,500	\$20,520	\$263,980	15.4	87,849

* - All incentives presented in this table are included as placeholders for planning purposes and are based on previously run state rebate programs. Contact your utility provider for details on current programs.

** - Simple Payback Period is based on net measure costs (i.e. after incentives).

*** - Negative payback explained in section 4.10

LIBRARY

#	Energy Conservation Measure	Cost Effective?	Annual Electric Savings (kWh)	Peak Demand Savings (kW)	Annual Fuel Savings (MMBtu)	Annual Energy Cost Savings (\$)	Estimated M&L Cost (\$)	Estimated Incentive (\$)*	Estimated Net M&L Cost (\$)	Simple Payback Period (yrs)**	CO ₂ e Emissions Reduction (lbs)
Lighting Upgrades			815	0.2	0	\$138	\$490	\$30	\$460	3.3	800
ECM 1	Retrofit Fixtures with LED Lamps	Yes	815	0.2	0	\$138	\$490	\$30	\$460	3.3	800
Lighting Control Measures			2,626	0.6	-1	\$446	\$4,610	\$1,410	\$3,200	7.2	2,579
ECM 2	Install Occupancy Sensor Lighting Controls	Yes	1,404	0.3	0	\$238	\$2,640	\$310	\$2,330	9.8	1,379
ECM 3	Install High/Low Lighting Controls	Yes	1,222	0.3	0	\$207	\$1,970	\$1,100	\$870	4.2	1,200
Variable Frequency Drive (VFD) Measures			14,026	3.2	0	\$2,417	\$11,400	\$1,200	\$10,200	4.2	14,124
ECM 4	Install VFDs on Constant Volume (CV) Fans	Yes	14,026	3.2	0	\$2,417	\$11,400	\$1,200	\$10,200	4.2	14,124
Unitary HVAC Measures			1,784	1.6	0	\$307	\$21,000	\$800	\$20,200	65.7	1,796
ECM 5	Install High Efficiency Heat Pumps	No	1,784	1.6	0	\$307	\$21,000	\$800	\$20,200	65.7	1,796
Gas Heating (HVAC/Process) Replacement			0	0.0	25	\$314	\$23,200	\$900	\$22,300	70.9	2,952
ECM 6	Install High Efficiency Hot Water Boilers	No	0	0.0	25	\$314	\$23,200	\$900	\$22,300	70.9	2,952
HVAC System Improvements			0	0.0	2	\$21	\$160	\$20	\$140	6.7	197
ECM 7	Install Pipe Insulation	Yes	0	0.0	2	\$21	\$160	\$20	\$140	6.7	197
Domestic Water Heating Upgrade			0	0.0	2	\$28	\$40	\$0	\$40	1.4	261
ECM 8	Install Low-Flow DHW Devices	Yes	0	0.0	2	\$28	\$40	\$0	\$40	1.4	261
Custom Measures***			-1,576	0.0	17	-\$60	\$2,500	\$0	\$2,500	-41.7	403
ECM 9	Replace Gas Fired Water Heater with Heat Pump Water Heater***	No	-1,576	0.0	17	-\$60	\$2,500	\$0	\$2,500	-41.7	403
TOTALS (COST EFFECTIVE MEASURES)			17,467	3.9	3	\$3,049	\$16,700	\$2,660	\$14,040	4.6	17,962
TOTALS (ALL MEASURES)			17,675	5.5	45	\$3,611	\$63,400	\$4,360	\$59,040	16.3	23,113

* - All incentives presented in this table are included as placeholders for planning purposes and are based on previously run state rebate programs. Contact your utility provider for details on current programs.

** - Simple Payback Period is based on net measure costs (i.e. after incentives).

*** - Negative payback explained in section 4.8

DPW GARAGES

#	Energy Conservation Measure	Cost Effective?	Annual Electric Savings (kWh)	Peak Demand Savings (kW)	Annual Fuel Savings (MMBtu)	Annual Energy Cost Savings (\$)	Estimated M&L Cost (\$)	Estimated Incentive (\$)*	Estimated Net M&L Cost (\$)	Simple Payback Period (yrs)**	CO ₂ e Emissions Reduction (lbs)
Lighting Upgrades			444	0.3	0	\$63	\$140	\$0	\$140	2.2	436
ECM 1	Retrofit Fixtures with LED Lamps	Yes	444	0.3	0	\$63	\$140	\$0	\$140	2.2	436
Lighting Control Measures			1,808	1.3	0	\$258	\$4,620	\$510	\$4,110	15.9	1,776
ECM 2	Install Occupancy Sensor Lighting Controls	No	1,808	1.3	0	\$258	\$4,620	\$510	\$4,110	15.9	1,776
Unitary HVAC Measures			193	0.2	0	\$28	\$7,000	\$400	\$6,600	235.3	195
ECM 3	Install High Efficiency Air Conditioning Units	Yes	193	0.2	0	\$28	\$7,000	\$400	\$6,600	235.3	195
HVAC System Improvements			286	0.0	1	\$55	\$280	\$40	\$240	4.3	435
ECM 4	Install Pipe Insulation	Yes	286	0.0	1	\$55	\$280	\$40	\$240	4.3	435
Domestic Water Heating Upgrade			65	0.0	1	\$21	\$20	\$0	\$20	1.0	184
ECM 5	Install Low-Flow DHW Devices	Yes	65	0.0	1	\$21	\$20	\$0	\$20	1.0	184
Custom Measures***			-1,182	0.0	13	-\$28	\$2,500	\$0	\$2,500	-89.3	332
ECM 6	Replace Gas Fired Water Heater with Heat Pump Water Heater***	No	1,182	0.0	13	-\$28	\$2,500	\$0	\$2,500	-89.3	332
TOTALS (COST EFFECTIVE MEASURES)			989	0.5	2	\$167	\$7,440	\$440	\$7,000	41.8	1,250
TOTALS (ALL MEASURES)			1,615	1.9	15	\$398	\$14,560	\$950	\$13,610	34.2	3,357

* - All incentives presented in this table are included as placeholders for planning purposes and are based on previously run state rebate programs. Contact your utility provider for details on current programs.

** - Simple Payback Period is based on net measure costs (i.e. after incentives).

*** - Negative payback explained in section 4.6

B & G SHOP

#	Energy Conservation Measure	Cost Effective?	Annual Electric Savings (kWh)	Peak Demand Savings (kW)	Annual Fuel Savings (MMBtu)	Annual Energy Cost Savings (\$)	Estimated M&L Cost (\$)	Estimated Incentive (\$)*	Estimated Net M&L Cost (\$)	Simple Payback Period (yrs)**	CO ₂ e Emissions Reduction (lbs)
Lighting Upgrades			180	0.1	0	\$46	\$50	\$0	\$50	1.1	177
ECM 1	Retrofit Fixtures with LED Lamps	Yes	180	0.1	0	\$46	\$50	\$0	\$50	1.1	177
Lighting Control Measures			717	0.4	0	\$183	\$3,100	\$240	\$2,860	15.6	703
ECM 2	Install Occupancy Sensor Lighting Controls	Yes	717	0.4	0	\$183	\$2,130	\$240	\$1,890	10.3	703
ECM 3	Install Photocell Controls	Yes	0	0.0	0	\$0	\$970	\$0	\$970	0.0	0
Unitary HVAC Measures			1,259	1.6	0	\$324	\$12,500	\$500	\$12,000	37.0	1,267
ECM 4	Install High Efficiency Air Conditioning Units	No	1,259	1.6	0	\$324	\$12,500	\$500	\$12,000	37.0	1,267
Gas Heating (HVAC/Process) Replacement			0	0.0	7	\$86	\$8,000	\$1,000	\$7,000	81.9	778
ECM 5	Install High Efficiency Furnaces	No	0	0.0	7	\$86	\$8,000	\$1,000	\$7,000	81.9	778
HVAC System Improvements			222	0.0	9	\$170	\$760	\$0	\$760	4.5	1,249
ECM 6	Install Programmable Thermostats	Yes	222	0.0	9	\$170	\$760	\$0	\$760	4.5	1,249
Domestic Water Heating Upgrade			139	0.0	0	\$36	\$10	\$0	\$10	0.3	140
ECM 7	Install Low-Flow DHW Devices	Yes	139	0.0	0	\$36	\$10	\$0	\$10	0.3	140
TOTALS (COST EFFECTIVE MEASURES)			1,258	0.4	9	\$434	\$3,920	\$240	\$3,680	8.5	2,269
TOTALS (ALL MEASURES)			2,517	2.0	15	\$844	\$24,420	\$1,740	\$22,680	26.9	4,314

* - All incentives presented in this table are included as placeholders for planning purposes and are based on previously run state rebate programs. Contact your utility provider for details on current programs.

** - Simple Payback Period is based on net measure costs (i.e. after incentives).

FIREHOUSE #2

#	Energy Conservation Measure	Cost Effective?	Annual Electric Savings (kWh)	Peak Demand Savings (kW)	Annual Fuel Savings (MMBtu)	Annual Energy Cost Savings (\$)	Estimated M&L Cost (\$)	Estimated Incentive (\$)*	Estimated Net M&L Cost (\$)	Simple Payback Period (yrs)**	CO ₂ e Emissions Reduction (lbs)
Lighting Upgrades			4,359	2.2	-1	\$732	\$5,150	\$780	\$4,370	6.0	4,287
ECM 1	Retrofit Fixtures with LED Lamps	Yes	4,359	2.2	-1	\$732	\$5,150	\$780	\$4,370	6.0	4,287
Lighting Control Measures			1,150	0.6	0	\$193	\$2,310	\$270	\$2,040	10.6	1,130
ECM 2	Install Occupancy Sensor Lighting Controls	Yes	1,150	0.6	0	\$193	\$2,310	\$270	\$2,040	10.6	1,130
Variable Frequency Drive (VFD) Measures			336	0.0	0	\$57	\$9,900	\$200	\$9,700	169.5	338
ECM 3	Install VFDs on Heating Water Pumps	Yes	336	0.0	0	\$57	\$9,900	\$200	\$9,700	169.5	338
Unitary HVAC Measures			1,267	0.9	0	\$216	\$9,200	\$0	\$9,200	42.6	1,276
ECM 4	Install High Efficiency Air Conditioning Units	Yes	1,267	0.9	0	\$216	\$9,200	\$0	\$9,200	42.6	1,276
Gas Heating (HVAC/Process) Replacement			0	0.0	25	\$299	\$14,100	\$400	\$13,700	45.9	2,889
ECM 5	Install High Efficiency Hot Water Boilers	Yes	0	0.0	25	\$299	\$14,100	\$400	\$13,700	45.9	2,889
HVAC System Improvements			0	0.0	14	\$170	\$390	\$40	\$350	2.1	1,642
ECM 6	Install Pipe Insulation	Yes	0	0.0	14	\$170	\$390	\$40	\$350	2.1	1,642
Domestic Water Heating Upgrade			0	0.0	1	\$15	\$20	\$0	\$20	1.3	144
ECM 7	Install Low-Flow DHW Devices	Yes	0	0.0	1	\$15	\$20	\$0	\$20	1.3	144
Food Service & Refrigeration Measures			1,612	0.2	0	\$275	\$270	\$50	\$220	0.8	1,623
ECM 8	Vending Machine Control	Yes	1,612	0.2	0	\$275	\$270	\$50	\$220	0.8	1,623
Custom Measures***			-2,007	0.0	21	-\$88	\$2,500	\$0	\$2,500	-28.4	438
ECM 9	Replace Gas Fired Water Heater with Heat Pump Water Heater***	Yes	-2,007	0.0	21	-\$88	\$2,500	\$0	\$2,500	-28.4	438
TOTALS (COST EFFECTIVE MEASURES)			6,717	3.9	60	\$1,868	\$43,840	\$1,740	\$42,100	22.5	13,767
TOTALS (ALL MEASURES)			6,717	3.9	60	\$1,868	\$43,840	\$1,740	\$42,100	22.5	13,767

* - All incentives presented in this table are included as placeholders for planning purposes and are based on previously run state rebate programs. Contact your utility provider for details on current programs.

** - Simple Payback Period is based on net measure costs (i.e. after incentives).

*** - Negative payback explained in section 4.9

WASTE WATER TREATMENT PLANT (1 OF 2)

#	Energy Conservation Measure	Cost Effective?	Annual Electric Savings (kWh)	Peak Demand Savings (kW)	Annual Fuel Savings (MMBtu)	Annual Energy Cost Savings (\$)	Estimated M&L Cost (\$)	Estimated Incentive (\$)*	Estimated Net M&L Cost (\$)	Simple Payback Period (yrs)**	CO ₂ e Emissions Reduction (lbs)
Lighting Upgrades			41,007	9.7	-3	\$4,981	\$39,460	\$5,320	\$34,140	6.9	40,897
ECM 1	Install LED Fixtures	Yes	32,606	4.5	-2	\$3,966	\$27,810	\$3,420	\$24,390	6.1	32,588
ECM 2	Retrofit Fluorescent Fixtures with LED Lamps and Drivers	Yes	348	0.3	0	\$42	\$620	\$70	\$550	13.1	342
ECM 3	Retrofit Fixtures with LED Lamps	Yes	8,053	5.0	-1	\$973	\$11,030	\$1,830	\$9,200	9.5	7,967
Lighting Control Measures			2,109	1.0	0	\$254	\$5,430	\$990	\$4,440	17.5	2,071
ECM 4	Install Occupancy Sensor Lighting Controls	Yes	1,912	0.9	0	\$230	\$4,110	\$490	\$3,620	15.7	1,878
ECM 6	Install High/Low Lighting Controls	Yes	197	0.1	0	\$24	\$840	\$500	\$340	14.4	193
Motor Upgrades			1,221	0.3	0	\$149	\$3,800	\$0	\$3,800	25.5	1,229
ECM 7	Premium Efficiency Motors	No	1,221	0.3	0	\$149	\$3,800	\$0	\$3,800	25.5	1,229
Variable Frequency Drive (VFD) Measures			293,957	50.4	0	\$35,931	\$102,000	\$1,700	\$100,300	2.8	296,012
ECM 8	Install VFDs on Constant Volume (CV) Fans	Yes	12,624	4.6	0	\$1,543	\$17,900	\$1,500	\$16,400	10.6	12,713
ECM 9	Install VFDs on Heating Water Pumps	No	3,551	0.4	0	\$434	\$9,400	\$200	\$9,200	21.2	3,576
ECM 10	Install VFDs on Process Pumps	Yes	277,782	45.4	0	\$33,954	\$74,700	\$0	\$74,700	2.2	279,724
Unitary HVAC Measures			2,429	2.0	0	\$297	\$12,300	\$700	\$11,600	39.1	2,446
ECM 11	Install High Efficiency Air Conditioning Units	No	2,429	2.0	0	\$297	\$12,300	\$700	\$11,600	39.1	2,446

WASTE WATER TREATMENT PLANT (2 OF 2)

#	Energy Conservation Measure	Cost Effective?	Annual Electric Savings (kWh)	Peak Demand Savings (kW)	Annual Fuel Savings (MMBtu)	Annual Energy Cost Savings (\$)	Estimated M&L Cost (\$)	Estimated Incentive (\$)*	Estimated Net M&L Cost (\$)	Simple Payback Period (yrs)**	CO ₂ e Emissions Reduction (lbs)
Gas Heating (HVAC/Process) Replacement			0	0.0	321	\$3,005	\$60,400	\$3,100	\$57,300	19.1	37,622
ECM 12	Install High Efficiency Hot Water Boilers	No	0	0.0	190	\$1,777	\$50,100	\$2,100	\$48,000	27.0	22,247
ECM 13	Install High Efficiency Furnaces	Yes	0	0.0	131	\$1,228	\$10,300	\$1,000	\$9,300	7.6	15,375
Food Service & Refrigeration Measures			1,612	0.2	0	\$197	\$270	\$50	\$220	1.1	1,623
ECM 14	Vending Machine Control	Yes	1,612	0.2	0	\$197	\$270	\$50	\$220	1.1	1,623
Custom Measures			-1,348	0.0	23	\$50	\$5,300	\$0	\$5,300	106.0	1,336
ECM 15	Replace Electric Water Heater with Heat Pump Water Heater	No	809	0.0	0	\$99	\$2,500	\$0	\$2,500	25.3	815
ECM 16	Replace Gas Fired Water Heater with Heat Pump Water Heater***	No	-2,157	0.0	23	-\$49	\$2,800	\$0	\$2,800	-57.1	521
TOTALS (COST EFFECTIVE MEASURES)			335,134	60.9	127	\$42,156	\$148,060	\$8,860	\$139,200	3.3	352,403
TOTALS (ALL MEASURES)			340,986	63.6	340	\$44,863	\$228,960	\$11,860	\$217,100	4.8	383,236

* - All incentives presented in this table are included as placeholders for planning purposes and are based on previously run state rebate programs. Contact your utility provider for details on current programs.

** - Simple Payback Period is based on net measure costs (i.e. after incentives).

*** - Negative payback explained in section 4.8

HILLWOOD WELL HOUSE

#	Energy Conservation Measure	Annual Electric Savings (kWh)	Peak Demand Savings (kW)	Annual Fuel Savings (MMBtu)	Annual Energy Cost Savings (\$)	Estimated M&L Cost (\$)	Estimated Incentive (\$)*	Estimated Net M&L Cost (\$)	Simple Payback Period (yrs)**	CO ₂ e Emissions Reduction (lbs)
Lighting Upgrades		1,192	0.2	0	\$667	\$590	\$60	\$530	0.8	1,201
ECM 1	Retrofit Fixtures with LED Lamps	1,192	0.2	0	\$667	\$590	\$60	\$530	0.8	1,201
Lighting Control Measures		209	0.0	0	\$117	\$660	\$80	\$580	5.0	211
ECM 2	Install Occupancy Sensor Lighting Controls	209	0.0	0	\$117	\$660	\$80	\$580	5.0	211
TOTALS		1,402	0.3	0	\$784	\$1,250	\$140	\$1,110	1.4	1,411

* - All incentives presented in this table are included as placeholders for planning purposes and are based on previously run state rebate programs. Contact your utility provider for details on current programs.

** - Simple Payback Period is based on net measure costs (i.e. after incentives).

VERONA COMMUNITY POOL

#	Energy Conservation Measure	Cost Effective?	Annual Electric Savings (kWh)	Peak Demand Savings (kW)	Annual Fuel Savings (MMBtu)	Annual Energy Cost Savings (\$)	Estimated M&L Cost (\$)	Estimated Incentive (\$)*	Estimated Net M&L Cost (\$)	Simple Payback Period (yrs)**	CO ₂ e Emissions Reduction (lbs)
Lighting Upgrades			19,008	8.5	0	\$3,737	\$3,990	\$980	\$3,010	0.8	19,141
ECM 1	Install LED Fixtures	Yes	2,593	0.0	0	\$510	\$2,020	\$800	\$1,220	2.4	2,611
ECM 2	Retrofit Fixtures with LED Lamps	Yes	16,415	8.5	0	\$3,227	\$1,970	\$180	\$1,790	0.6	16,530
Lighting Control Measures			1,920	0.7	0	\$377	\$4,530	\$540	\$3,990	10.6	1,934
ECM 3	Install Occupancy Sensor Lighting Controls	Yes	1,920	0.7	0	\$377	\$4,530	\$540	\$3,990	10.6	1,934
Variable Frequency Drive (VFD) Measures			37,767	0.0	0	\$7,424	\$19,600	\$2,200	\$17,400	2.3	38,031
ECM 4	Install VFDs on Process/Pool Filtration Pumps	Yes	37,767	0.0	0	\$7,424	\$19,600	\$2,200	\$17,400	2.3	38,031
Domestic Water Heating Upgrade			0	0.0	15	\$386	\$690	\$120	\$570	1.5	2,498
ECM 5	Install Low-Flow DHW Devices	Yes	0	0.0	15	\$386	\$690	\$120	\$570	1.5	2,498
Food Service & Refrigeration Measures			3,224	0.4	0	\$634	\$540	\$100	\$440	0.7	3,246
ECM 6	Vending Machine Control	Yes	3,224	0.4	0	\$634	\$540	\$100	\$440	0.7	3,246
TOTALS (COST EFFECTIVE MEASURES)			61,919	9.5	15	\$12,558	\$29,350	\$3,940	\$25,410	2.0	64,850
TOTALS (ALL MEASURES)			61,919	9.5	15	\$12,558	\$29,350	\$3,940	\$25,410	2.0	64,850

* - All incentives presented in this table are included as placeholders for planning purposes and are based on previously run state rebate programs. Contact your utility provider for details on current programs.

** - Simple Payback Period is based on net measure costs (i.e. after incentives).

ENERGY EFFICIENT BEST PRACTICES



- Reduce Air Leakage
- Close Doors and Windows
- Develop a Lighting Maintenance Schedule
- Ensure Lighting Controls Are Operating Properly
- Use Fans to Reduce Cooling Load
- Use Window Treatments/Coverings
- Clean and/or Replace HVAC filters
- Check and Seal Duct Leakage
- Perform Proper Boiler Maintenance
- Perform Proper Water Heater Maintenance
- Plug Load Controls
- Water Conservation

See individual reports for specific EE Best Practices by building

WATER BEST PRACTICES



- Leak Detection and Repair
- Toilets and Urinals
- Faucets and Showerheads
- Commercial Kitchen Equipment
- Laundry Equipment
- Cooling Towers
- Steam Boiler System
- Pools and Spas
- Laboratory and Medical Equipment
- Water Metering and Submetering
- Vehicle Washing
- Single Pass Cooling System
- Landscaping and Irrigation
- On-Site Alternative Water Sources



See individual reports for specific Water Best Practices by building

MEASURES FOR FUTURE CONSIDERATION

- Installation of Energy Management System
- Electric Submetering
- Pool Heating System Upgrades
- Heating System Conversion from Steam to Hot Water
- Window Replacements
- VRF Systems
- High Speed Insulated Overhead Doors
- Upgrade to a Heat Pump System

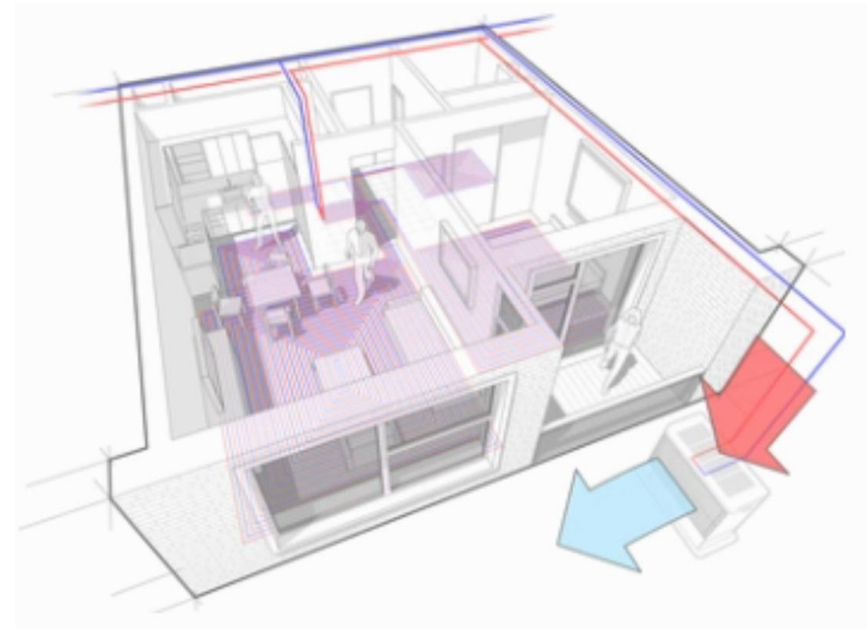

EV CHARGING STATION POTENTIAL

NJCleanEnergy.com/EV

Know your EV Charging Stations

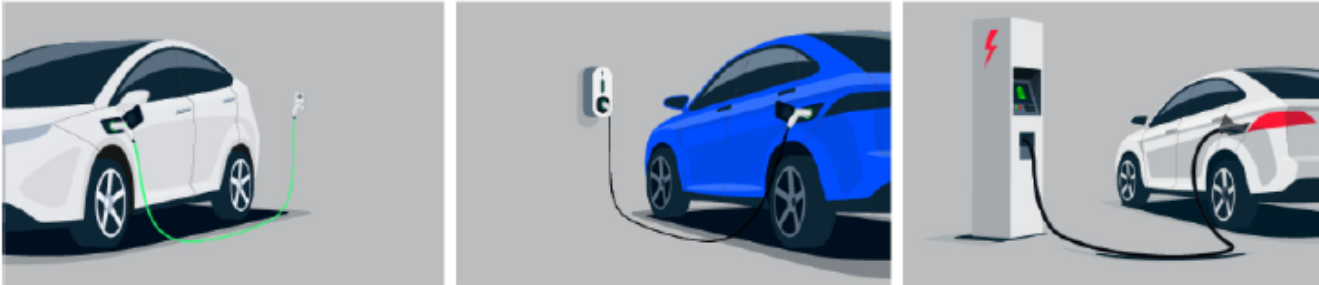

LEVEL 1



4-6 miles/hour
Replenish Rate



7-30 hours for full charge

Approximate time to charge a battery*

CHARGE
110/120V

LEVEL 2



10-20 miles/hour
Replenish Rate



2-10 hours for full charge

Approximate time to charge a battery*

CHARGE
208/240V

DIRECT CURRENT (DC) FAST CHARGING*



120-200 miles/hour
Replenish Rate



20-90 minutes for full charge

Approximate time to charge a battery*

CHARGE
480V or 208V

*dependent on the size of the battery

	Township of Verona
Potential:	Varies Refer to Reports



SOLAR ENERGY GENERATION POTENTIAL

NJCleanEnergy.com/renewable-energy

	Community Center	Verona Community Pool
<i>Potential:</i>	High	MEDIUM
<i>System Potential: (kW)</i>	107	59
<i>Electric Generation: (kWh per year)</i>	127,477	70,291
<i>Displaced Cost: (per year)</i>	\$27,970	\$13,820

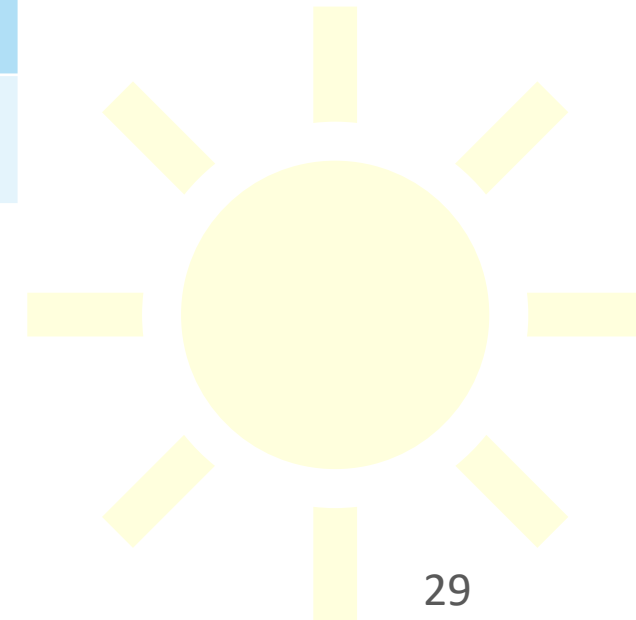

FINANCING MECHANISM: ESIP

NJCleanEnergy.com/ESIP

ENERGY SAVINGS IMPROVEMENT PROGRAM (ESIP)

- Energy Performance Contracting = NJ ESIP Program
- A creative tool and financing mechanism that allows public entities to make energy efficiency improvements without impacting their budgets
- Administered by the NJBPU
- Project is paid for with the value of its own energy savings
- 2 Options: Lease Purchase Loan or Bond
- 15 or 20 year pay back term
- NJBPU Approved Incentive Programs
 - Utility or NJCEP
- Can be combined with Federal/State Grants
- No upfront capital expenses
- No referendum or impact to tax payers



ENERGY SAVINGS IMPROVEMENT PROGRAM

NJCleanEnergy.com/ESIP

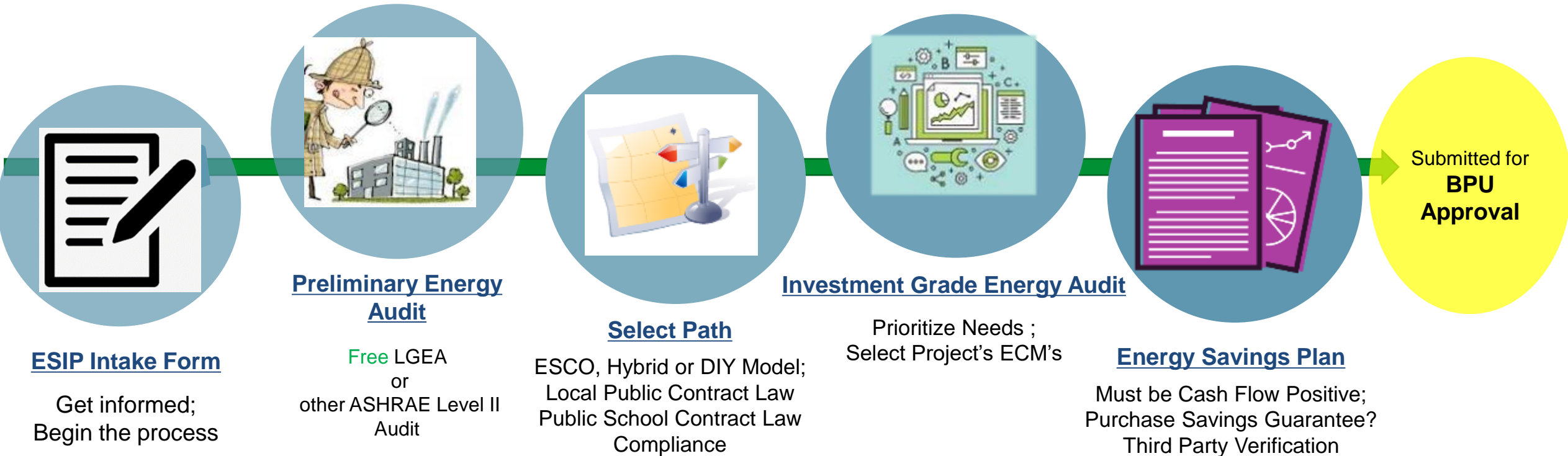

ENERGY SAVINGS IMPROVEMENT PROGRAM

NJCleanEnergy.com/ESIP

FOR MORE INFORMATION

Michelle Rossi

ESIP Coordinator

ESIP@bpu.nj.gov

o: 609.913.6295

c: 609.915.0903

SUSTAINABLE JERSEY – DIRECT PAY



Combining NJBPU Incentives with Direct Pay

Direct Pay (Elective Pay), part of Inflation Reduction Act (IRA), allows tax-exempt entities, including municipalities and school districts, to receive tax credits for clean energy projects.

About Direct Pay

- All eligible projects receive tax credits (not competitive)
- Currently authorized for 10 years
- Projects completed in 2023 are eligible for tax credits until Nov 15
For local governments filing on a calendar year, fiscal year deadline is May 15

Eligible Projects Include

- Renewables – solar, geothermal, wind, etc.
- Electric vehicles
- Electric vehicle charging infrastructure (*limited*)
- Combined heat and power; Electric storage

Direct Pay can be used in combination with other funding sources like NJBPU incentives.

Example

Lightweight EV	\$24,000
NJBPU Clean Fleet Grant	-\$4,000
Direct Pay Tax Credit	-\$7,500
Total cost to entity	\$12,500

Note: Total incentive can not exceed total project cost.

For more information, visit Sustainable Jersey's [Direct Pay Tax Credits page](#).

Full list of Direct Pay eligible tax credits at <https://www.irs.gov/pub/irs-pdf/p5817a.pdf>

C&I ENERGY EFFICIENCY PROGRAMS

NJCleanEnergy.com

LOCAL
GOVERNMENT
CUSTOMERS

COMMERCIAL &
INSTITUTIONAL
CUSTOMERS

LARGE
ENERGY
CUSTOMERS

EXISTING BUILDINGS

MEASUREMENT & AUDITS

FREE Energy Audits



RETROFITS

Prescriptive &
Custom Rebates

Direct Install

Engineered Solutions

And more from
your local utility!



Incentives up
to \$4 million
for eligible projects



NEW CONSTRUCTION

Prescriptive & Custom
Rebates for New
Construction and
Gut Rehabs

Pay for Performance
incentives for
buildings over
50,000 sq. ft.



DISTRIBUTED ENERGY RESOURCES

Combined Heat & Power
and Fuel Cell Installation
Incentives

Microgrid Development

Battery Storage

Muni EV Fleets



Key:

Programs run by investor-owned utility companies



Programs run by NJCEP



UTILITY RUN ENERGY EFFICIENCY PROGRAMS*

NJCleanEnergy.com/Transition

PRESCRIPTIVE & CUSTOM REBATES:

- Individual high efficiency equipment rebates for renovation, remodeling, and equipment replacement
- Flexibility to do a little or a lot
- No size requirement

DIRECT INSTALL:

- Turn-key retrofit program to replace outdated and inefficient equipment including, lighting, HVAC, refrigeration, etc.
- The facility must have an average electric peak demand <200kW in the previous year to qualify

ENERGY MANAGEMENT :

- Includes the Building Tune-up (BT), Retro-commissioning (RCx), and Strategic Energy Management (SEM) subprograms. These subprograms offer a comprehensive mix of custom energy-savings measures such as basic HVAC tune-ups, building systems tune-ups, controls' calibration, diagnostic testing, and installation of measures to enhance your building's energy performance and savings.

ENGINEERED SOLUTIONS:

- Comprehensive, whole-building approach to saving energy
- The facility must have an average electric peak demand >200kW in the previous year to qualify

**Other programs may be available to you. Check with your Utility Provider to see a full list of offering and what you may be qualified for.*



UTILITY RUN ENERGY EFFICIENCY PROGRAMS

PSE&G

Dave Kirsch – David.Kirsch@pseg.com
Steve Barba – Steven.T.Barba@pseg.com

FOR MORE INFORMATION

Sarah Walters – LGEA Project Manager

SWalters@trccompanies.com

(732) 589-7372

Moussa Traore – LGEA Technical Manager

MTraore@trccompanies.com

(732) 902-1797

Melissa Lott – LGEA Account Manager

MLott@trccompanies.com

(732) 589-7397

Sayje Essoka-Lasenberry – LGEA Energy Auditor

Sessoka-lasenberry@trccompanies.com

(862) 308-3185

Ryan Knippenberg – LGEA Energy Auditor

RKnippenberg@trccompanies.com

(732) 439-7184

THANK YOU

